

Purlin Connections

Side Rail Purlin Connection

Please contact the Sales Office for our complete Purlin guide.

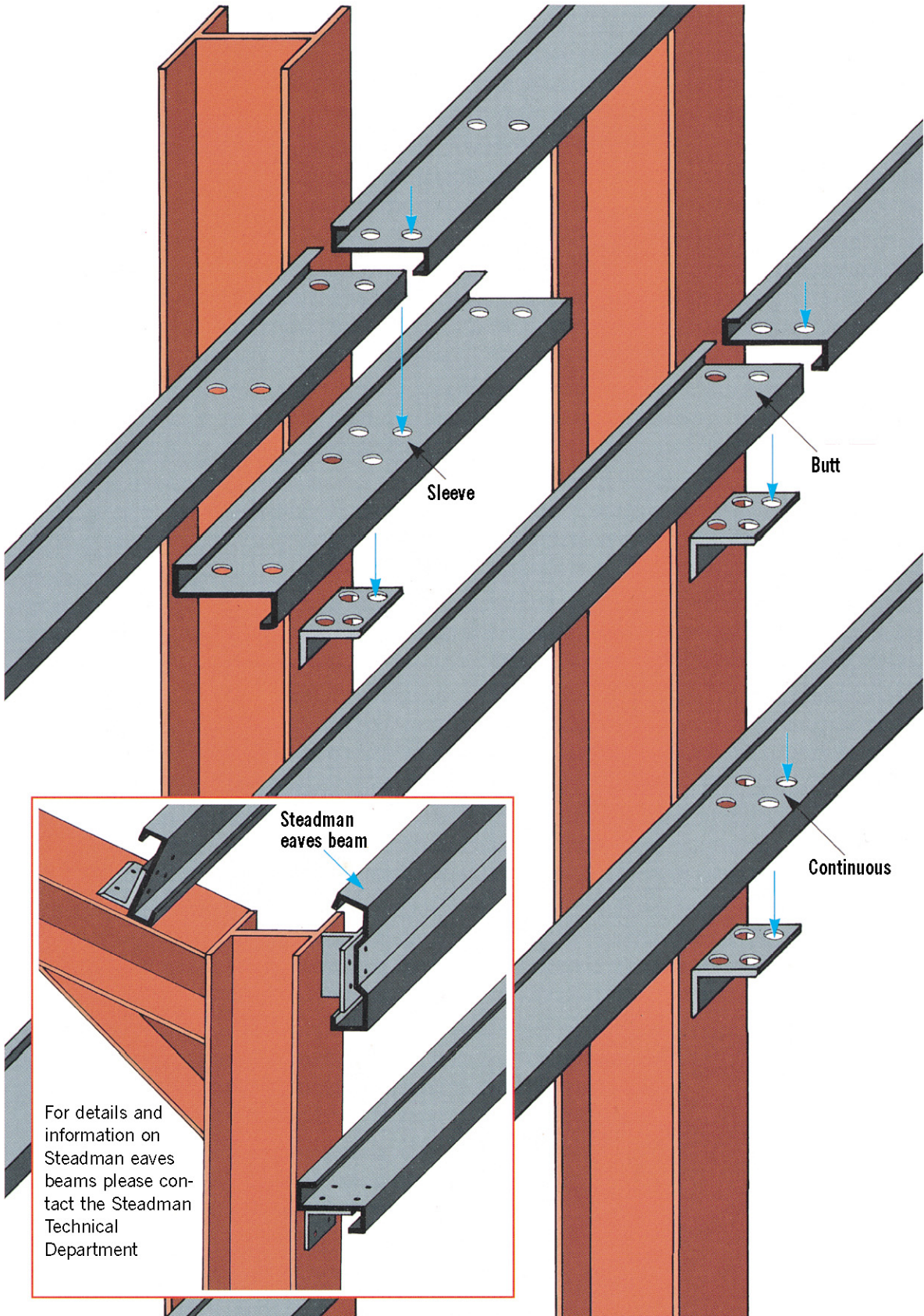

Purlin Connection

Roof Purlin Connections

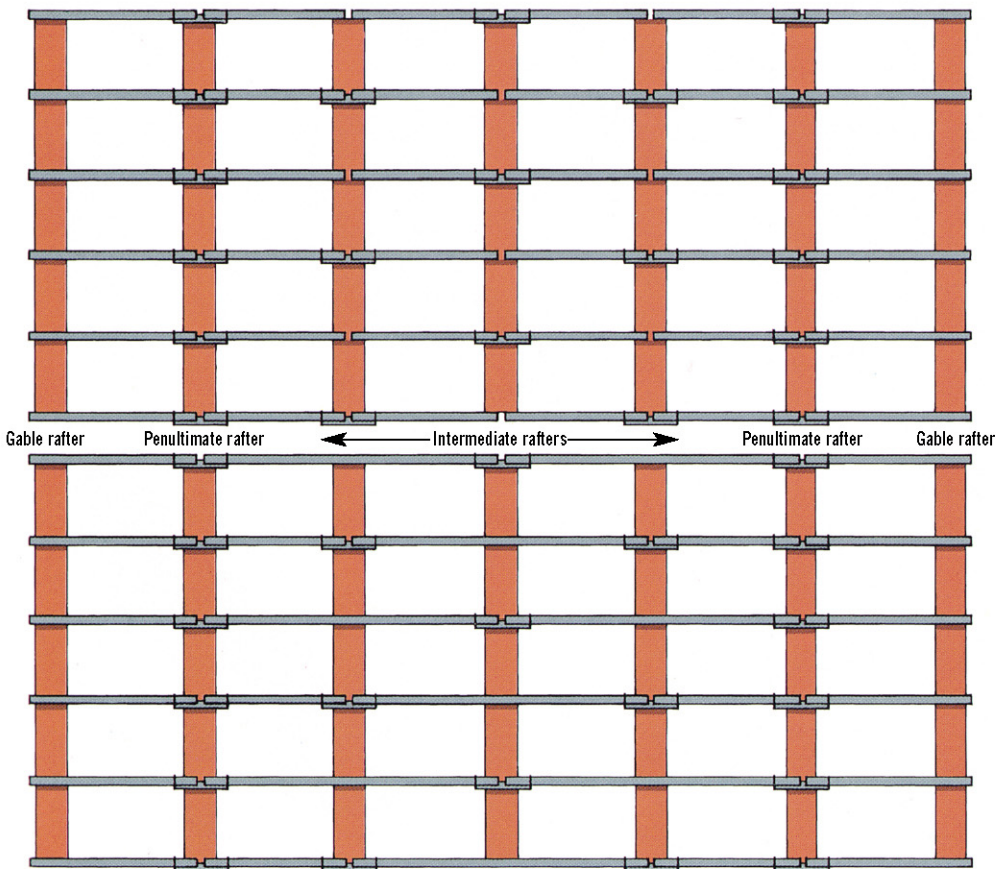
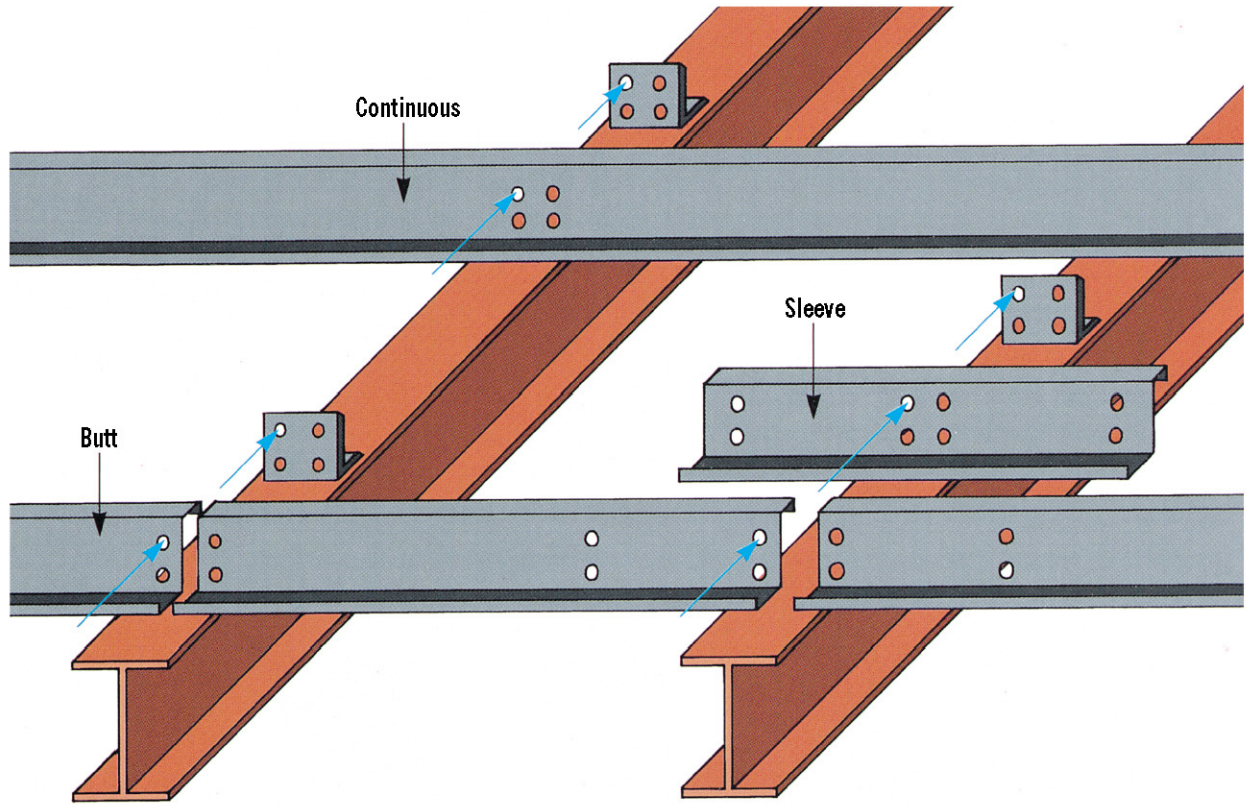

PURLIN OR SIDE RAIL ARRANGEMENT SINGLE SPAN LENGTHS

Sleeves required on all purlins on penultimate rafters and on alternate joints on intermediate rafters.

PURLIN OR SIDE RAIL ARRANGEMENT SINGLE AND DOUBLE SPAN LENGTHS

All butt joints should be connected using a standard cleat details.

Purlin Sections

Standard Hole Punching

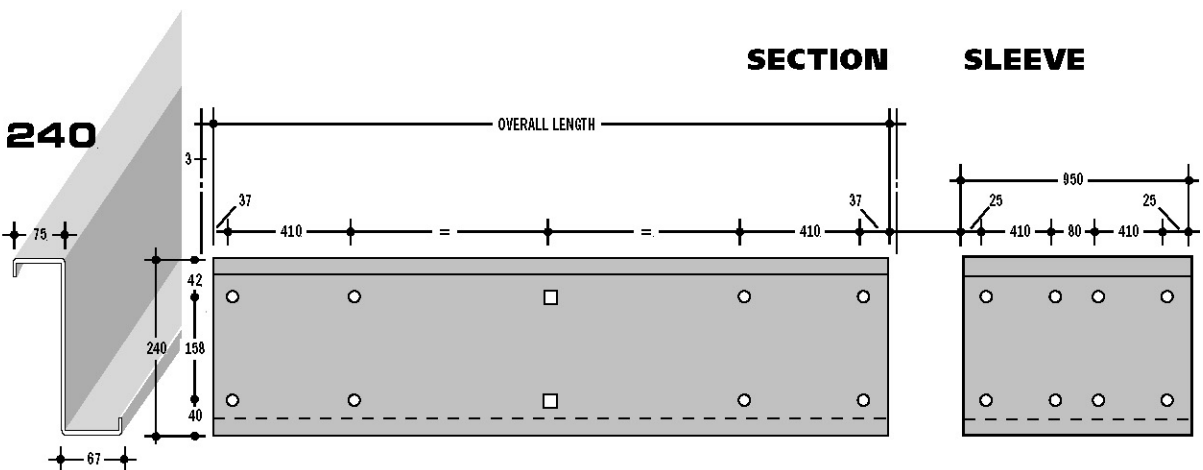
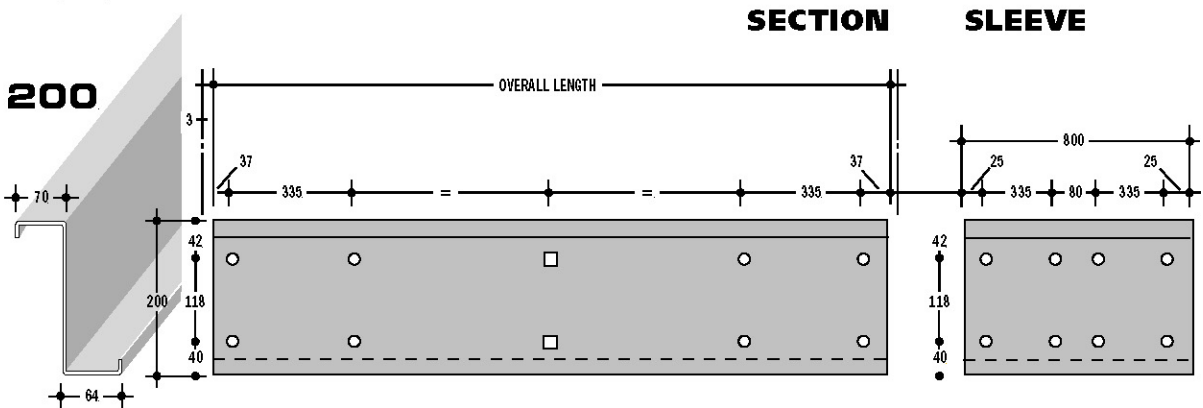
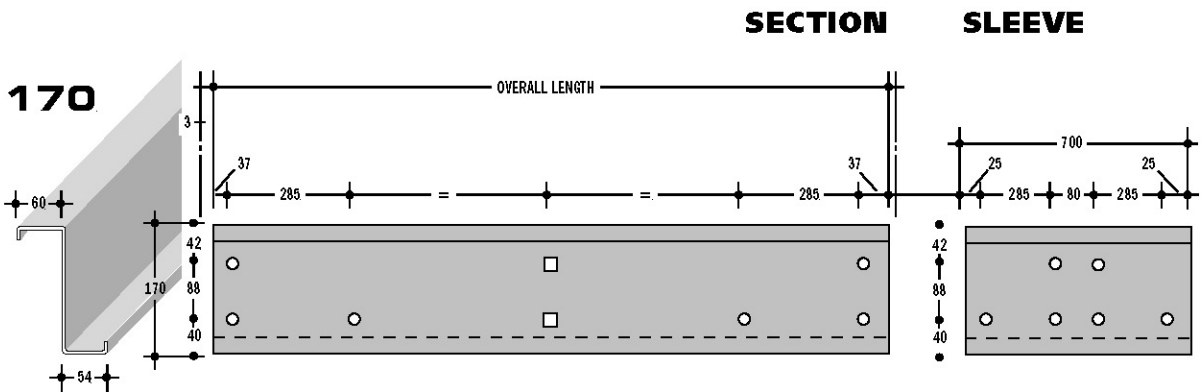
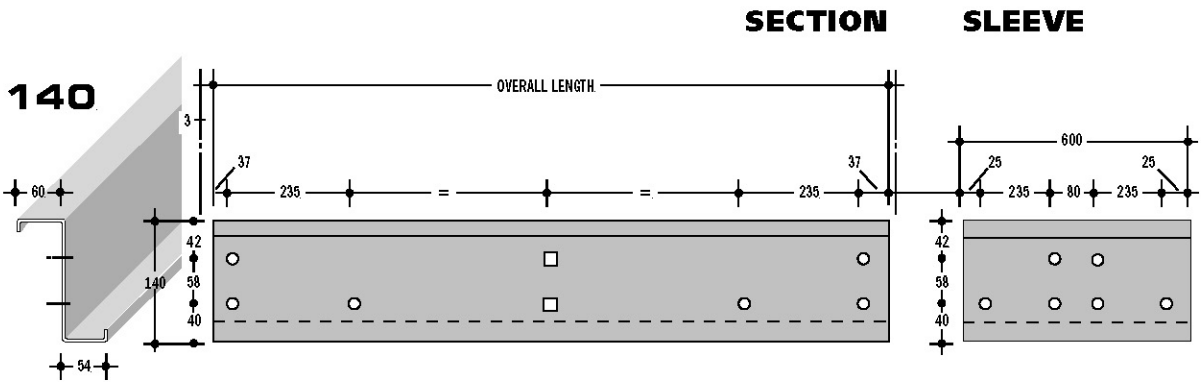

Purlin Sections

Cleat & Sag Bars

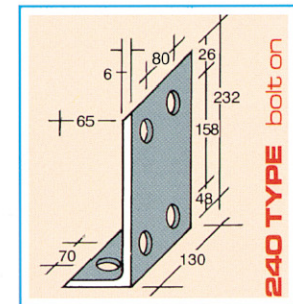
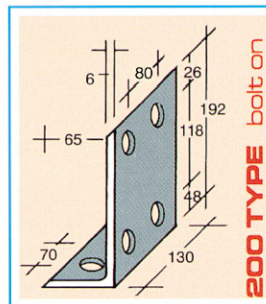
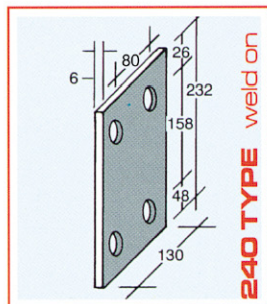
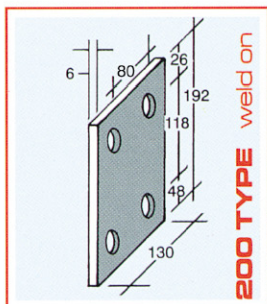
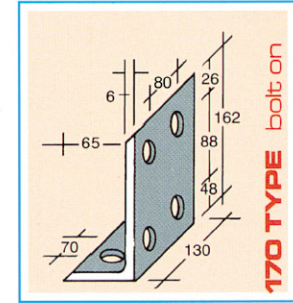
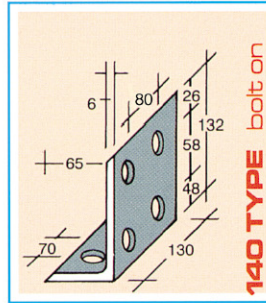
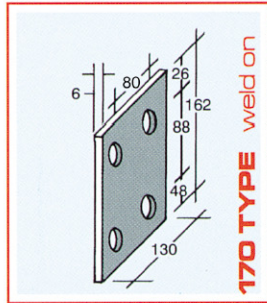
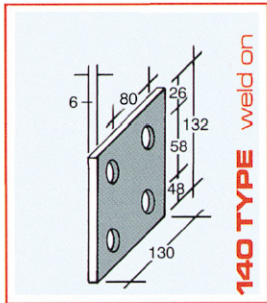

ANTI-SAG BARS

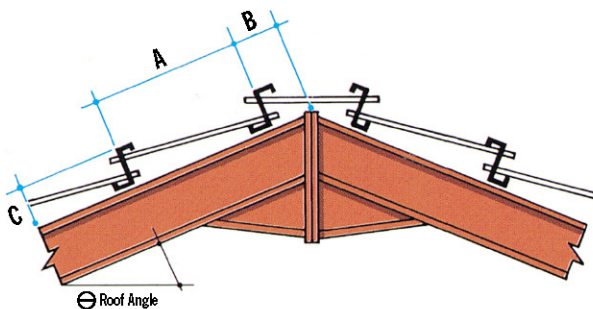

Typical Anti-Sag Bar details for 10° to 30° when ordering please quote dims A, B, & C and angle ⊖

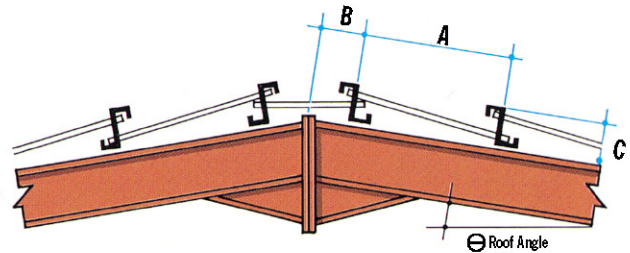

Typical Anti-Sag Bar details for 30 to 100 when ordering please quote dims A, B, & C and angle ⊖

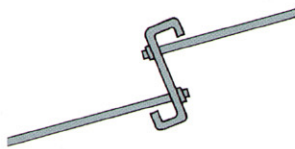

Steadman standard push fit anti-sag bars

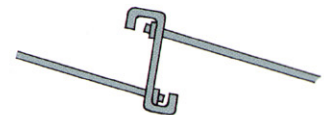

MONO PITCHED ROOF LAYOUT AND ANTI-SAG BAR GUIDE

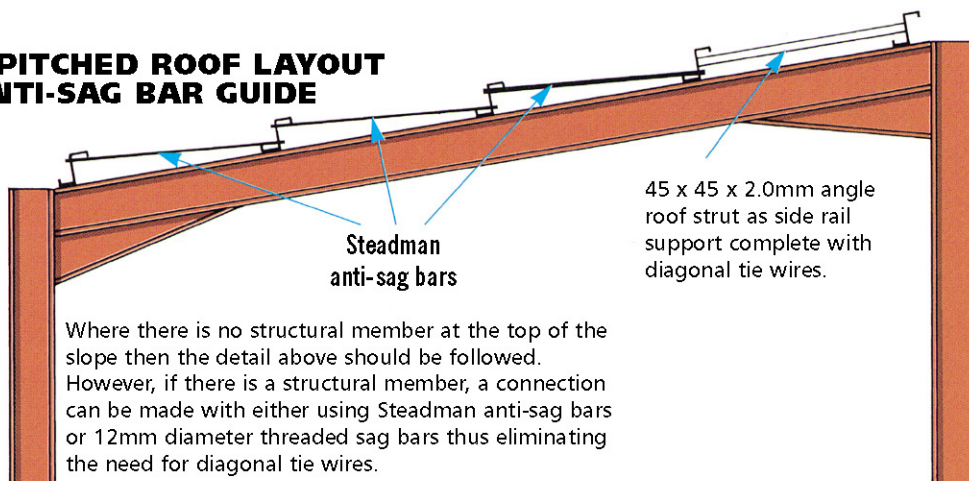

Where there is no structural member at the top of the slope then the detail above should be followed. However, if there is a structural member, a connection can be made with either using Steadman anti-sag bars or 12mm diameter threaded sag bars thus eliminating the need for diagonal tie wires.